



## **POLIVAC MM1700E AUTO SCRUBBER**



## **Operations Manual & Trouble Shooting Guide**

## SAFE OPERATING PROCEDURES 1700E AUTO SCRUBBER

**DO NOT use this machine unless you are fully conversant in its safe use and operation and appropriate training has been given.**

**Let the machine do the work.**  
**Avoid twisting and awkward postures.**  
**Weight over your feet – stand naturally.**  
**Share the load - take turns with your team partner.**



### PERSONAL PROTECTION EQUIPMENT

No loose clothing and covered footwear should be used when operating this machine.

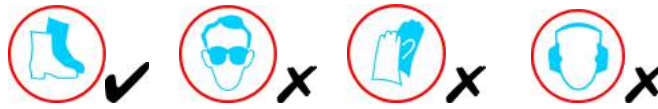

### PRE-OPERATIONAL SAFETY CHECKS

1. The operator's hand should be run along the total length of the lead to check for cuts or other damage as the lead is rolled out / rolled up.
2. No electrical machine should be used unless it contains current Test and Tag requirements.
3. Please remove the extension lead prior to adding solution to the tank.
4. Check lead is correctly fitted to the cable restraint so that no tension is applied to the sockets.
5. Power to the machine should be disconnected at the wall socket prior to cleaning the equipment, undertaking any form of repairs or changing the brush/pad.
6. Trail electrical lead behind you as you work.
7. Under no circumstance should extension leads be used with this machine.

### STARTING AND USING THE AUTO SCRUBBER

1. Plug the lead into the power socket and turn the switch on.
2. Stand upright; all operations with this equipment should be undertaken with the intention of maintaining the back's natural curves.
3. Place the brush/pad holder underneath the machine and move to centre as much as possible. Then lower the machine and press the "BRUSH" switch to engage the brush
4. Once the brush/pad is engaged press the "BRUSH" switch to ON position. Then MM1700E will start to move forward slowly by itself, via the Poliflow forward propulsion System
5. To remove the brush/pad holder from the machine, lift the machine head and switch ON "BRUSH" switch. That should release the brush from coupling
6. To release fluid from the solution tank, press "SOLUTION" switch to ON position. If no solution is noticed on the floor then check the solution valve located near the bottom of the tank along the solution path and turn it to on. Please note this solution valve can be used as a mode to control volume of solution that flows on to the brush/pad.
7. Please lower the lever attach to the back of the tank to lower the squeegee assembly to the floor. Then press the "VACCUM" switch to ON position.
8. Always start at power point end of work area and work away from it with the electric cord behind you. Do **NOT** place lead over your shoulder while operating the machine.

### **STARTING AND USING THE AUTO SCRUBBER CONTINUE.....**

9. If you lose control of the machine, press the “BRUSH” switch to OFF position.  
machine will immediately stop forward motion
10. Please note machine will automatically come to stop once recovery tank is full. This is Controlled by a float switch installed in the recovery tank. In order to continue using the machine, please make sure following
  - a) Press “ BRUSH” , “SOLUTION , “ VACCUM” switches to off position
  - b) Then drain the dirt water in the tank sensibly
11. Please note machine tend stop/start frequently when the recovery tank is near full.

### **HOUSEKEEPING**

When you are finished the job, ensure the recovery tank is emptied, via the clear hose situated on the right rear of the tank. A bucket is best to use for this. Simply unscrew the top valve and the fluid will pour out. Rinse out the recovery tank with a hose and repeat the process to ensure the tank is completely clean.

1. If you have left over solution in the tank then press the “SOLUTION” switch to ON position (while power is connected). That should empty the solution left over in tank
2. Wipe machine over after each use. Care should be taken to clean the underside of the machine.
3. Remove the pad or brush (refer to # 5 above) from the 1700E. Clean pad or brush, with strong stream of fresh water. Allow to dry thoroughly before storing.
4. Remove the squeegee tool and rinse it under running water, ensure that all dirt and debris is removed from the squeegee blade.
5. Wipe cord, to clean and check for any damage, each time you roll it up. Wind from machine end always to avoid twisting.
6. Equipment should be stored in a secure location with the skirt sitting neatly around the machine.
7. All attachments should be removed and stored suitably e.g. on a shelf or in boxes.
8. Electrical cords should be coiled and tied for protection against damage and for ease of storing.

### **POTENTIAL HAZARDS**

1. Slip, trip and fall hazards exist when operating this machine.
2. Do not store MM1700 in upright position with brush or pad holder attached.
3. Take care not to run MM1700E over cable.
4. Do not store other equipment or items on top of this scrubber.
5. Do NOT place lead over your shoulder while operating the machine.

### TROUBLE SHOOTING

ISSUE	SOLUTION
Machine doesn't work when "BRUSH", "SOLUTION" & "VACCUM" switches are ON	1) Check extension lead connection to the inlet socket in the machine and to the wall socket 2) Recovery tank may be full. Empty the tank
"VACCUM" switch is ON but no suction	1) Check Squeegee assembly has been lowered to the floor 2) Recovery tank lid may not be closed properly
Machine moves to the side ways but not straight	1) Height adjusting knob located at the back of casting to be adjusted carefully if machine pulling to left then turn anti clockwise if machine pulling to right then turn clockwise
Dirty water still on the floor and hasn't been sucked properly	Clean squeegee blades to remove dirt and debris

NEW MM1700E

VPV191K ( SWITCH)

PVT104 (SQUEEGEE  
ASSEMBLY WITH BLADES)

KAR013( SQUEEGY BLADES, A PAIR

KAR106( CASTOR WHEEL)

Brush/Pad holder operation, solution releasing operation  
as well as vacuum motor operations are controlled by  
individual rocker switches in the latest MM1700E MODEL



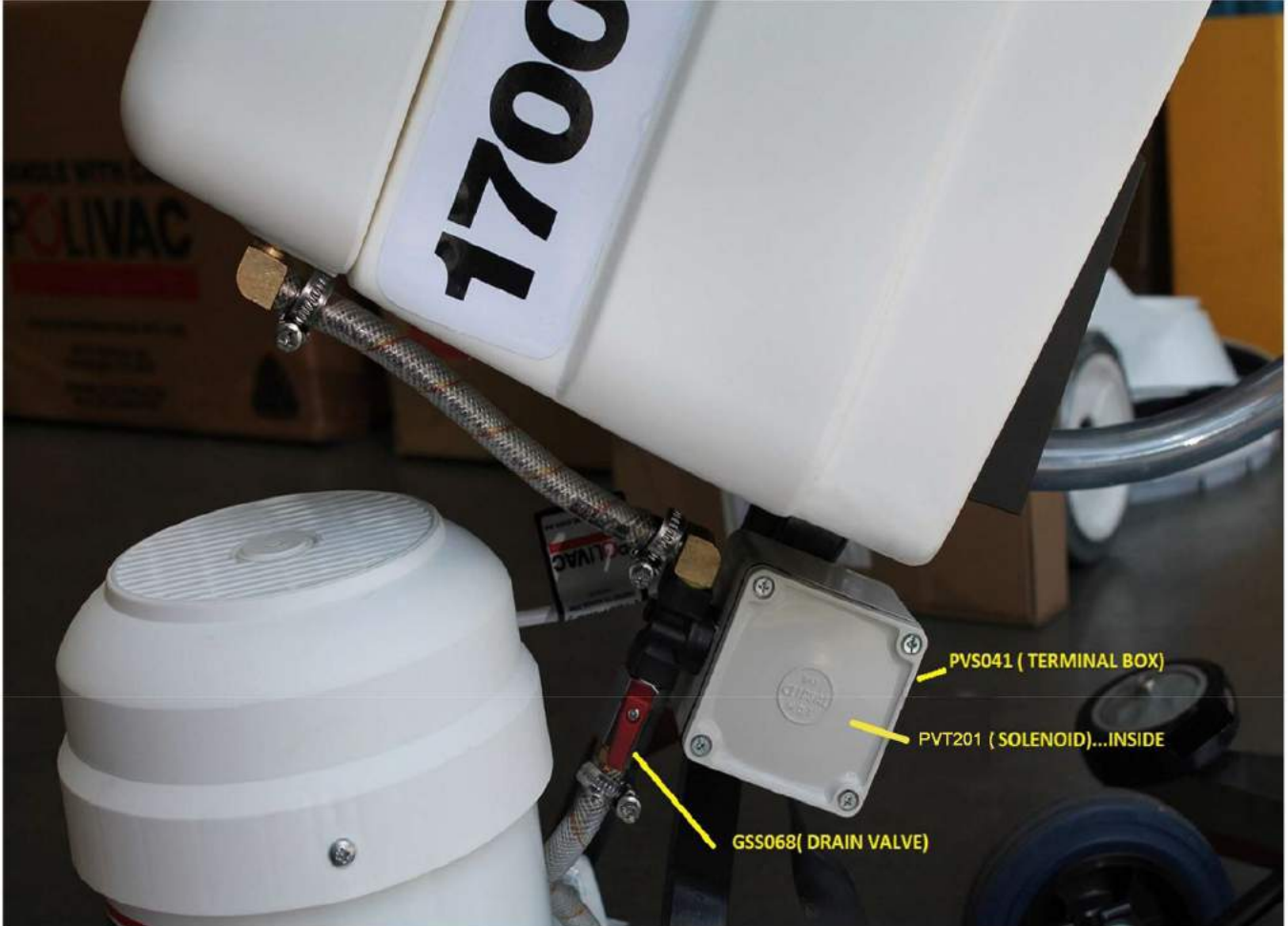

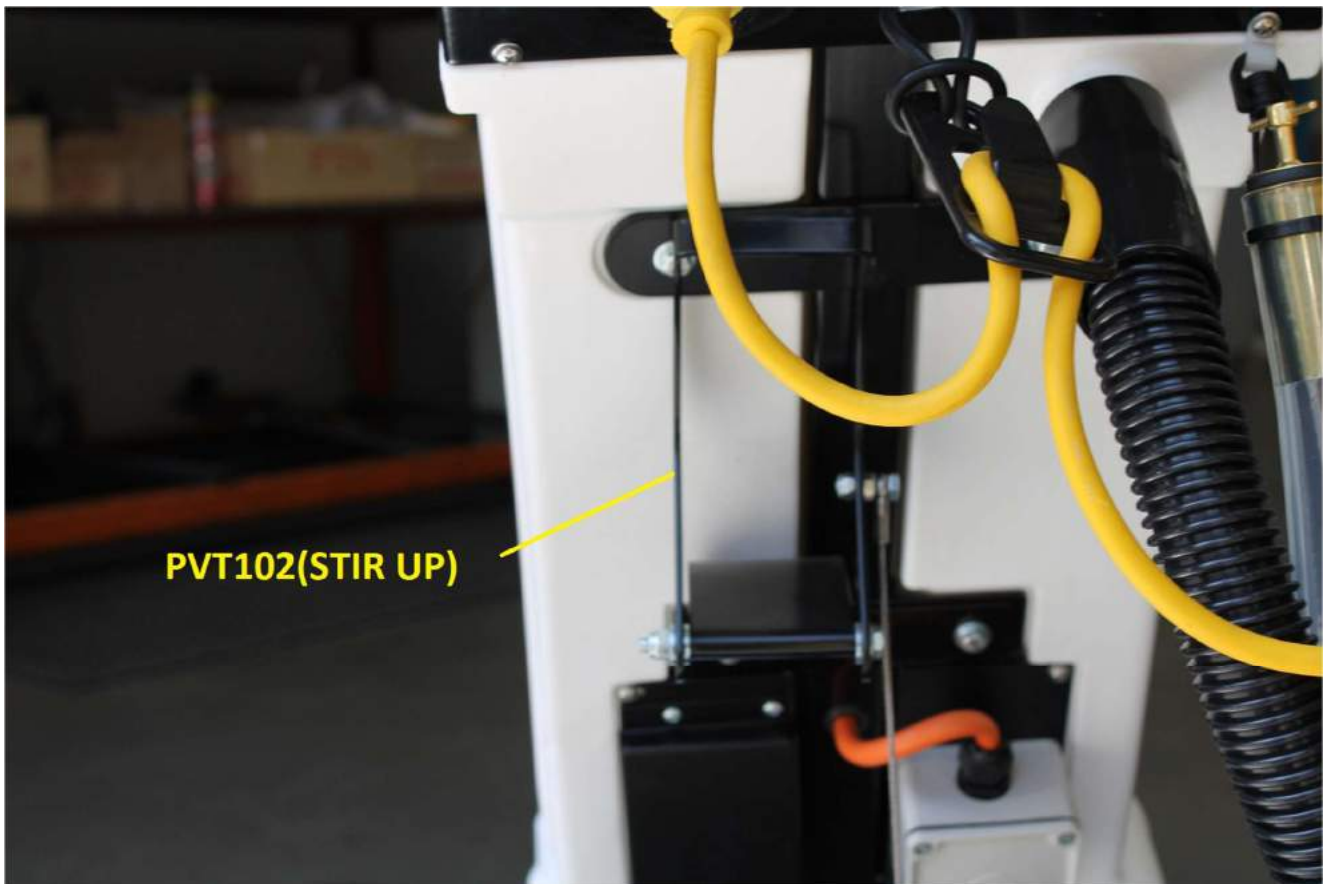

# 1700E Autoscrubber

## PARTS LIST

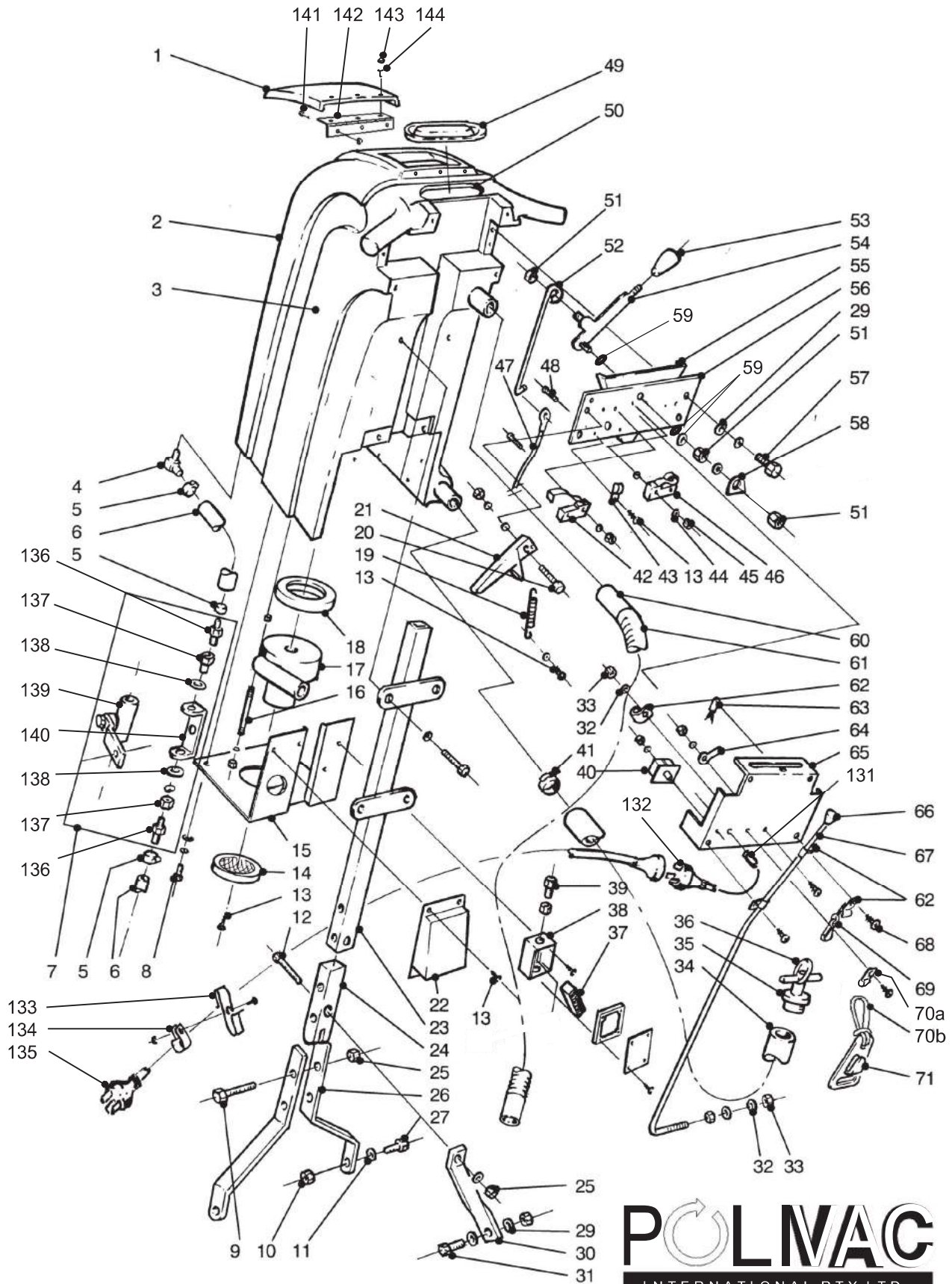

**POLNAC**  
INTERNATIONAL PTY LTD



# 1700E Autoscrubber

## PARTS LIST

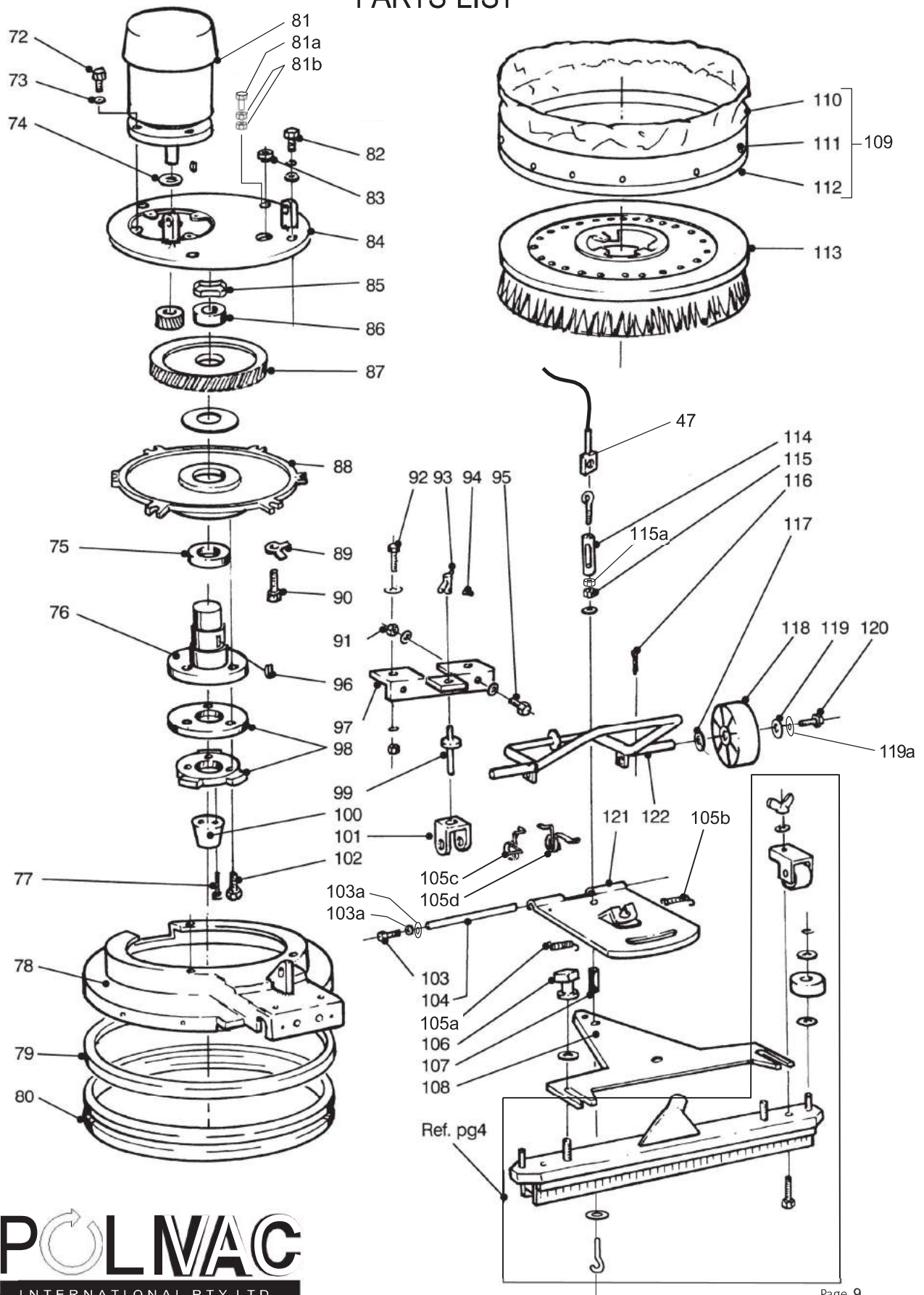

# 1700E Autoscrubber

## PARTS LIST

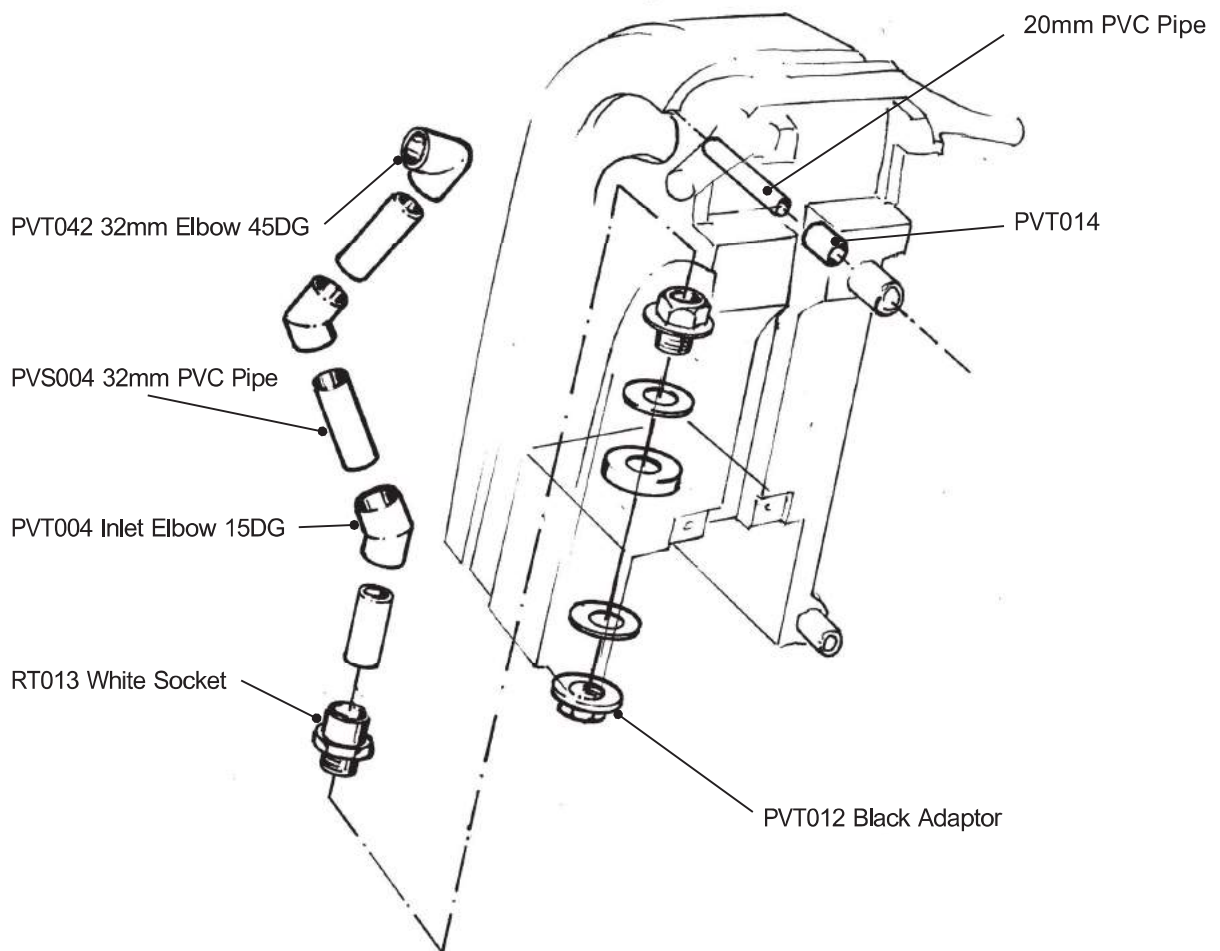

# 1700E Autoscrubber

## PARTS LIST

1.	PVT005	Lid (Solution Tank)	80	VPV087	Buffer
2.	PVT001	Solution Tank	81	VPA328CMG	Drive Motor
3.	PVT001A	Recovery Tank	81a	SK006	Screw 5/16
4	PVT035	Elbow Fitting	81b	VPV542	Nut 5/16
5	PVS060	Hose Quick Clamp	82	AAD041	Screw
6	PVS067	Solution Hose	83	VPA836	Rubber Grommet
7	PVS013	Solution Valve Assembly	84	VPA177	Base Plate
8	AAA537	6mm x 12mm Set Screw	85	VPA121	Wavy Washer
9	AAD039	Bolt	86	VPA570	Bearing
10	VPA284	Nut	87	VPA411	Gear
12	AAD038	1/4 x 1½	88	VAA113	Cover Plate
14	COM019	Rubber Seal	89	VPA122	Washer
15	PVT100D	Bottom Plate (Vac Cover)	90	AAA564	Set Screw 1/4 x ¾
16	PVT033	Spring	91	PVT045	Nut 5/16
17	PVT002	Vac Motor	92	PVT044	Cap Head Screw 5/16
18	COM086	Seal (Motor Support)	93	PVS085	Knob
			94	PVS042	Gcrub Screw
			95	PVT044	Cap Head Screw 5/16
			96	VFB115	Woodruff Key
22	PVT100J	Exhaust Cover	97	PVT090	Height Adjustment Wedment
23	PVT100A	Handle Stem	98	PVS078	Drive Hub
24	VPA231	Tongue Assembly	99	PVS009	Height Adjustment Rod
25	AAF140	1/4 Nylon Nut	100	387116	Pilot Hub
26	VPA767	Fork	101	PVS087	Height Adjustment Bracket
27	VPA284	Handle Pin & Nut	102	PVS026	Cap/Head Screw 5/16 x 11/4
28	SLB038	3/16 Nylon Nut	103	AAA564	Set Screw 5/8 x ¼
			103a	GAS041	¼ Spring Washer
30	PVT086	Support Bracket (Handle)	103b	AAG236	Washer
31	AAA604	Bolt (H/T 1/4 x 1) S/S	104	PVS092	Shaft
32	PVT027	Flat Washer	105a	PVS118L	Left Spring
33	SLB038	3/16 Nylon Nut	105b	PVS119R	Right Spring
34	PVS077	Water Release Hose	105c	PVS119L	Left Spring
35	PVT047	Plug PVT048 Sleeve	105d	PVS118R	Right Spring
36	VPV156	Ring	106	370711	Thumb Nut
37	PVS974	Terminal Block (5 Term)	107	VPA820	Spacer (Swivel Tongue & Squeegee)
38	PVS041	Wiring Box	108	PVS006	Swivel Squeegee
39	PVS096	Gland	109	PVS052	Skirt Assembly
40	AAM601	Terminal Block	110	VPV168	Mini Skirt (ref 109 Skirt Assy.)
41.	PVT200	Hose Clamp	111	VPV172	Retainer Skirt (ref 109 Skirt Assy.)
			112	VPV042	Pickup Ring (ref 109 Skirt Assy.)
			113	PVS40B2	Brush
			114	PVT009	Turn Buckle
			115	PPR095	Nut Nylon
			115a	PVS039	S/S Nut 3/16
			116	VPA829	5/32 Roll Pin
			117	PVT038	Flat Washer
49.	PVT006	Lid (Recovery Tank)	118	PVT007A	Wheels
50.	PVT015	Rubber Seal	119	SLB040	Flat washer
			119a	GAS041	Spring Washer ¼
			120	AAA564	Set Screw 5/8 x ¼
			121	PVS006	Swivel Squeegee Tongue
			122	PVT011	Axle
			133	300187	Belt Clip
60	PVS095	Hose Cuff	134	PVS070	Plastic Clamp
61	PVS121	Extract Hoset	135	VPV476	Extension Lead
65	PVT100F	Cover Plate	136	VPV459	Brass Barb 5/16
66	387670	Knob (Detergent Lift Handle)	141	PVT029	Screw 6G X 1/2 SS
69	VPV120	Clip (Hose Retainer)	142	PVT018	Hinge
70a	VVA019	Cable Clamp No.4	143	AAE232	Dom Nut
70b	BV8003	Ring	144	AAK044	Pop Rivet
71	BV8003	Strain Relief			
72	AAA564	Set Screw 1/4 x ¾			
73	AAG236	Flat Washer			
74	VPA104	Oil Seal			
75	VPA114	Bearing			
76	VPA116	Shaft			
77	AAA501	3/16 x 1"			
78	PVS424	Casting			
79	VPV239	Insert			

PAGE5 PVT102 STIR UP

# 1700E/A23 VPA328CMG

- |    |           |                     |
|----|-----------|---------------------|
| 1  | VPV818CMG | Capacitor Box Cover |
| 2a | VPV797CMG | Start Capacitor     |
| 2b | VPV825CMG | Run Capacitor       |
| 3  | VPV817CMG | Capacitor Box Base  |
| 4  | VPV807CMG | Manual Reset        |
| 5  | VPV813CMG | Cowl                |
| 6  | VPV812CMG | Cooling Fan         |
| 6a | VPV819CMG | Clip on cooling fan |
| 7  | VPV811CMG | Non Drive Endshield |
| 8  | VPV826CMG | Switch Plate        |
| 9  | VPV806CMG | Centrifugal Switch  |
| 10 | VPV810CMG | Flanged Endshield   |

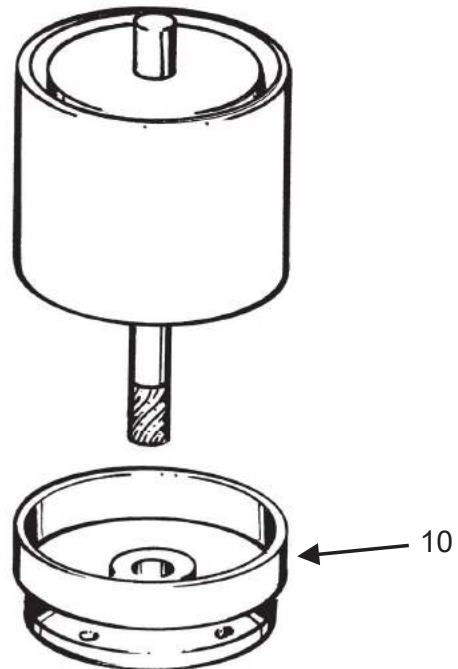
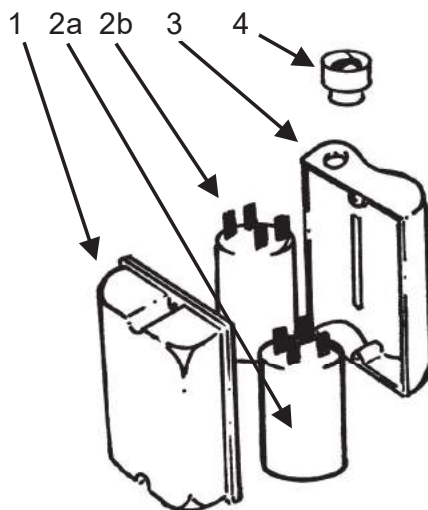
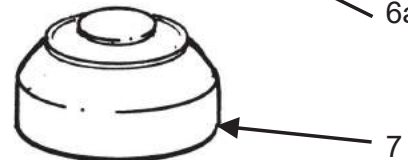
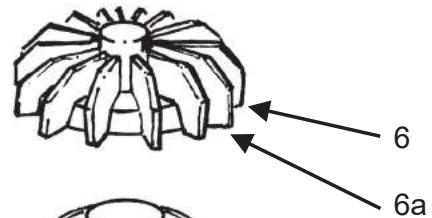
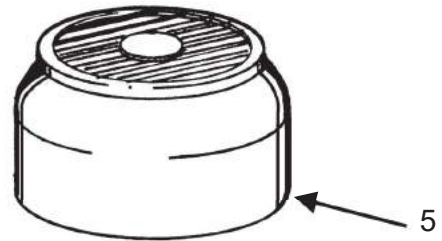



# WARRANTY POLICY

1. When a warranty repair is requested, the purchaser must first contact any of Polivac's authorized Service Centres with proof of purchase and details of the alleged defect. In most instances, the request for warranty brought to the attention of our Service Centres or Agents is handled in a prompt routine manner with no question as to its validity. However, some requests for warranty are not justified. In these cases, product owners will be made aware that the premature failure of their product was the result of a cause not covered by Warranty.
2. The Polivac warranty covers only DEFECTIVE MATERIAL and/or DEFECTIVE WORKMANSHIP. It does not cover labour.
3. Polivac products are warranted for twelve (12) months from date of purchase by the original purchaser against faulty workmanship or material. The warranty covers only the replacement, repair or adjustment of any part which in the opinion of Polivac fails because of a fault in materials or workmanship:
  - a) drive motors and gearbox assemblies on electrical products carry a two (2) years warranty
  - b) bodies of carpet extraction products and vacuum cleaners carry a three (3) years conditional warranty.
  - c) battery warranty of twelve (12) months is as provided by the manufacturer. Terms available on request.
4. Where the product has been rented out by a Hire or similar company, the warranty period is reduced to three (3) months.
5. This warranty does not cover service calls, travelling time or consumable parts - e.g. drive belts, chains, flexible skirts or hoses, dust bags, mains leads, brushes, buffers, buffer strips, sanding discs, light bulbs, nozzles, filters, pressure pumps, piston seals, diaphragms, squeegees and like items.
6. In the case of proprietary components used by the manufacturer in the product, such as engines, electrical motors, chargers and the like, Polivac will pass on any warranty provided by the manufacture of such items.
7. Accidental damage, abuse, misuse or neglect of the product is not covered by warranty.
8. Fair wear and tear and where the product has been used other than for the purpose for which it was designed is not covered by warranty.
9. Use of non-approved chemicals and detergents in the product will void the warranty.
10. Products that have been modified are not covered by warranty.
11. Products that have not been serviced at their recommended intervals by an authorised Polivac Service Centre or Agent are not covered by warranty
12. Damage to, or failure of, the product which has resulted from low or high voltage, the use of an incorrectly sized extension lead, or a coiled electrical extension lead is not covered by warranty.
13. Repairs carried out on the product by any person other than an authorized Polivac repairer will void the warranty.
14. All freight charges to and from the manufacturer, agent or service centre will be the responsibility of the distributor.
15. A charge for traveling time and labour will be applicable for on-site warranty service.
16. Polivac reserves the right to replace defective parts of the product with parts or components of similar quality, grade and composition where an identical part or component is not available. Goods presented for repair may be replaced by refurbished goods of the same type rather than being repaired.

**POLIVAC WARRANTY IS SUBJECT TO THE LAWS AND REGULATIONS OF THE INDIVIDUAL STATES AND COMMONWEALTH TERRITORIES OF AUSTRALIA. THIS WARRANTY IS NOT TRANSFERRABLE.**

